



Panoramic Vista

Panoramic View 2BHK Apartments

Bicholim, Goa



Panoramic Vista

20 residential apartments situated in Bicholim-Goa. This complex hosts all facilities and features that a contemporary home buyer would desire to have. The Project is surrounded with calm green valley area of great connection is ensured here via many wide roads. Residential of the location get easy access to general public resources like schools, hospitals, recreational zones and areas. Panoramic Vistas floor plan provides best use of the space. From stylish floor to roomy balconies and high-quality fittings, everything here provides it an appealing appearances



TYPE A



TYPE B

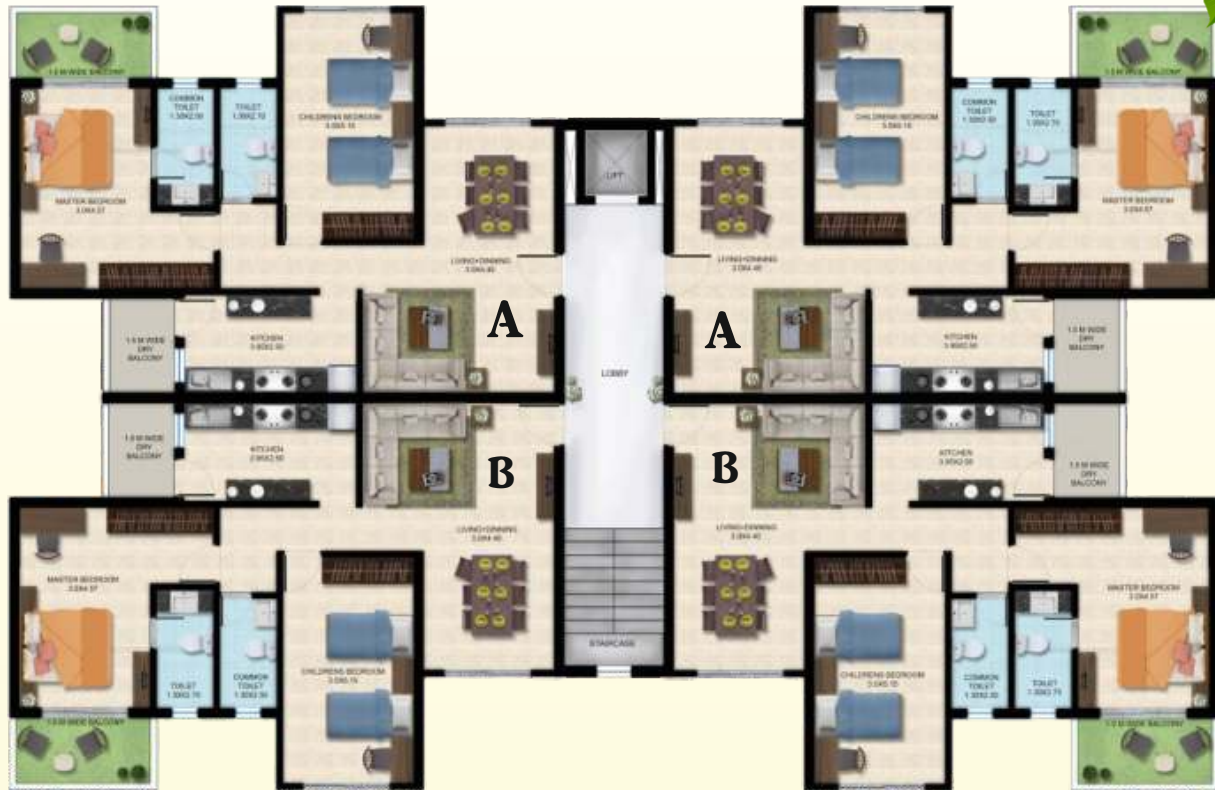

TYPICAL 2 BHK FLOOR PLAN

AMENITIES

- STILT PARKING • CLUB HOUSE • LIFT • GARDEN • SECURITY
- DESIGNER LOBBY • WATERBODY

DISTANCE FROM THE PROJECT

Panoramic View 2BHK Apartments

ITI Bicholim	500mtrs
Hotel D'lila	1.5kms
Bicholim Market	2.5kms
Bicholim bus stand	2.5kms
Shantadurga School	3kms
Govt. Hospital	3.5kms
Mayem Lake	4kms
Mopa Airport	29kms
Panaji	31kms

Site Plan



Location Map

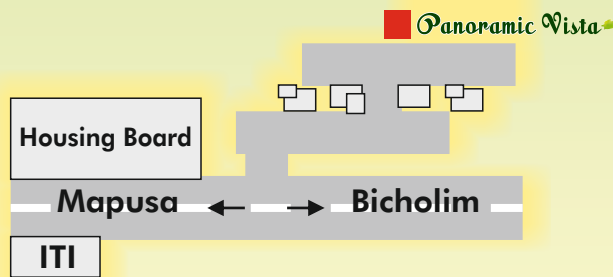

Amenities

- 1 Security Gate, Guard Room
- 2 Landscape Garden
- 3 Club House
- 4 Water Body
- 5 Elevator
- 6 Exclusive Parking
- 7 Cameras & Compound wall

Project Developed by:



7721-975-999



sales@goapropertyhub.com



www.goapropertyhub.com

* The information contained in this leaflet is subject to change as may be required by the authorities or the company and cannot form part of an offer or contract. All measurements and distances are approximate.